



11 Valley Drive Royalla NSW

5 3 20

Take full advantage of a softening market to snap up a superbly renovated family home well below replacement cost. With meticulous craftsmanship, this stunning property boasts an array of luxury features including multiple living areas and an expansive alfresco entertaining area.

With private, quiet leafy surrounds on a large 7.75acre block this inviting & expansive family home is well worth a look. Immaculately presented inside & out this home is beautifully framed in the stunning park like landscaped grounds.

This attractive home features a generous combined lounge/dining area adjoining a well-appointed modern kitchen with large pantry, plenty of storage and quality top end appliances. The expansive north facing open plan living area is bathed in light and is the central hub of this

Land Size : 31423 sqm
View : <https://www.rapportproperty.com.au/sale/nsw/capital-monaro-snowy/royalla/residential/house/7365069>



Marc Donohue
0417 646 417



1/FLOOR PLAN

FLOOR AREA
324 SQ.M

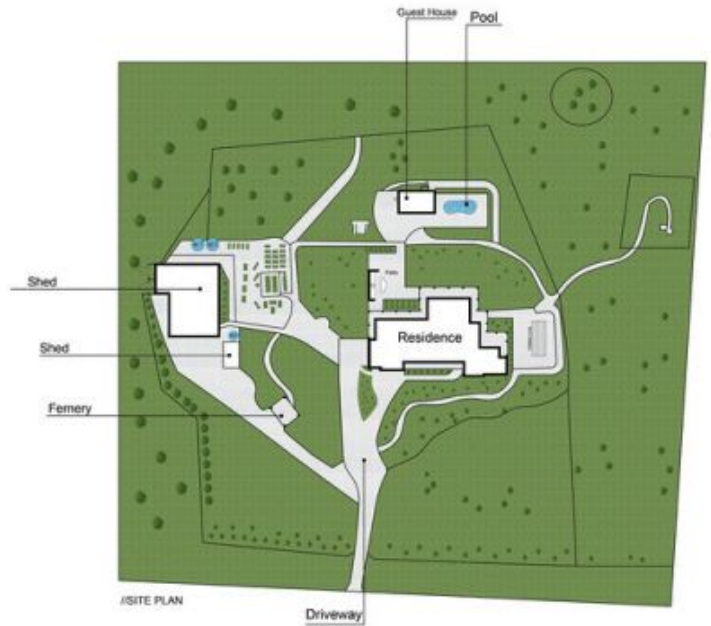

1/SITE PLAN

Whilst every attempt has been made to ensure the accuracy of the floor plan contained here, measurements of doors, windows, rooms and any other items are approximate and no responsibility is taken for error, omission or mis-statement. This plan is for illustrative purposes only and should only be used as such by any prospective purchaser.